

POA-2013-50, Yukon River

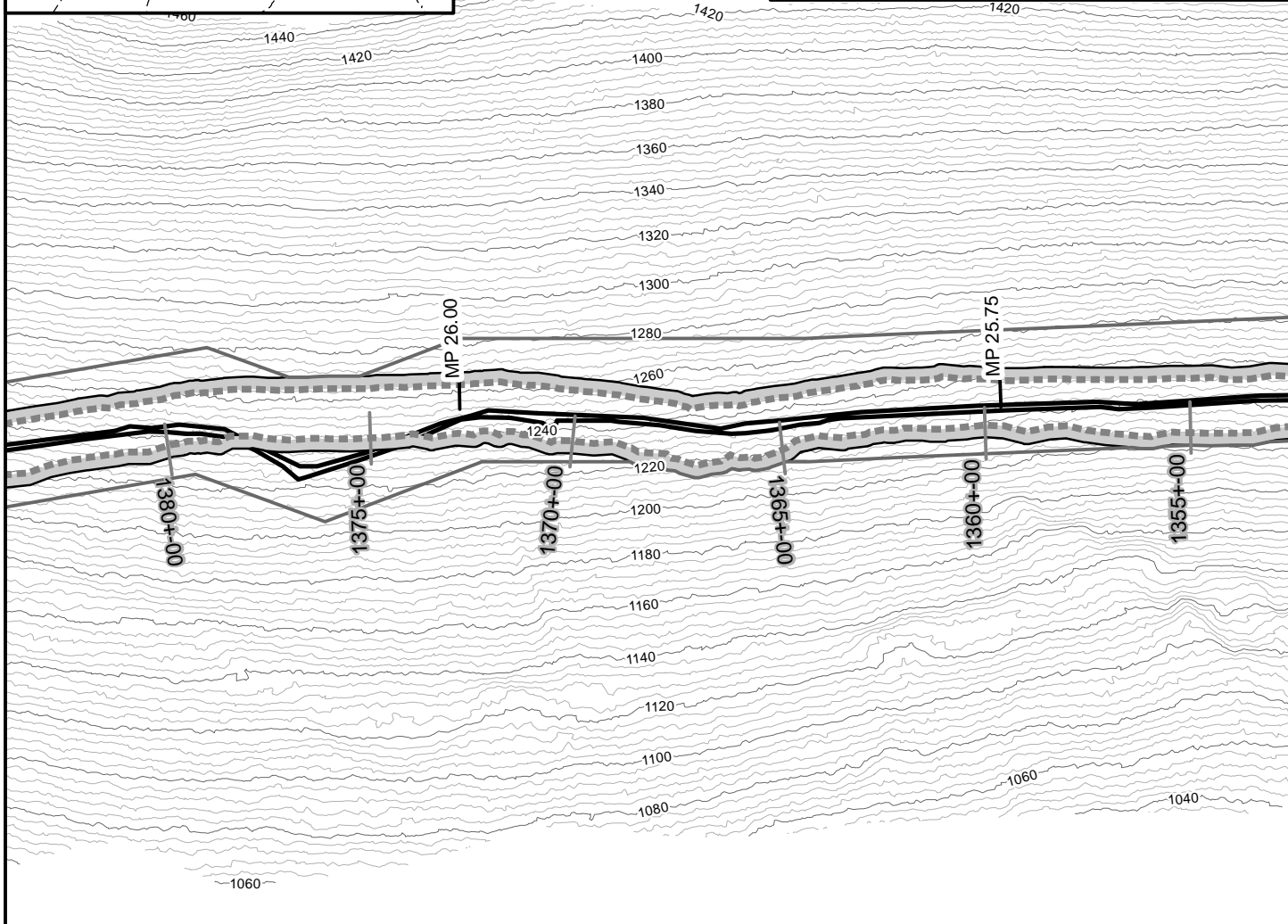
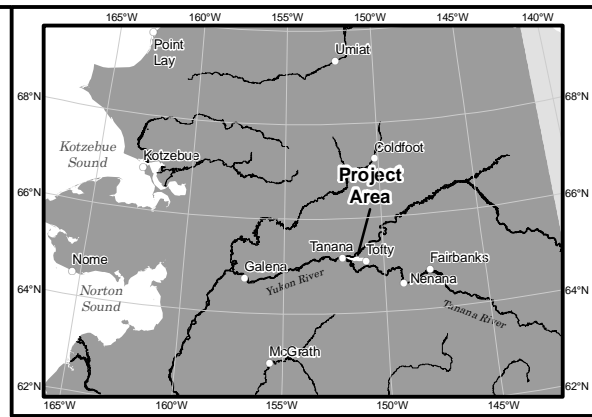
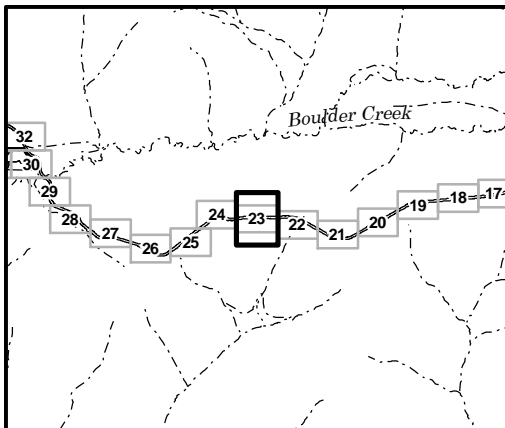

Q:\Projects\280_3PPI\tanana_2012\mxds_40\ARDL_Tanana_404_Corps_5K_8x11_1of66_v01.mxd 02/08/13 01:15 PM

Legend

	Cut/Fill Boundary		Material Site
	Vegetation Clearing		Culvert: Type A & B Pipe (See Cross Section Figures 70, 71, 72 & 73)
	Vegetative Screen/Buffer		Culvert: Fish Pass Pipe (See Cross Section Figures 94, 95, 72 & 73)
	3PPI Study Area Boundary (12/05/2012)		MS Section Cut Lines
	Wetland		20ft Interval Contour
	Upland		4ft Interval Contour
	Wetland/Upland Mosaic		3PPI Arcs (12/5/2012) (All drainages are unnamed unless labeled on sheet)
	Navigable Waters		
	Other Waters		
	Previously Disturbed		

Scale 1:5,000
0 150 300 450 Feet

STATE OF ALASKA
Department of Transportation and Public Facilities

APPLICANT/AGENT: State of Alaska
2301 Peger Rd. Fairbanks, AK 99709

ROAD TO TANANA PROJECT

61759

Plan View, MP: 25.62 to 26.2

Fish Creek Basin

DATE: FEBRUARY 2013	SHEET: 23 of 110
---------------------	------------------

POA-2013-50, Yukon River

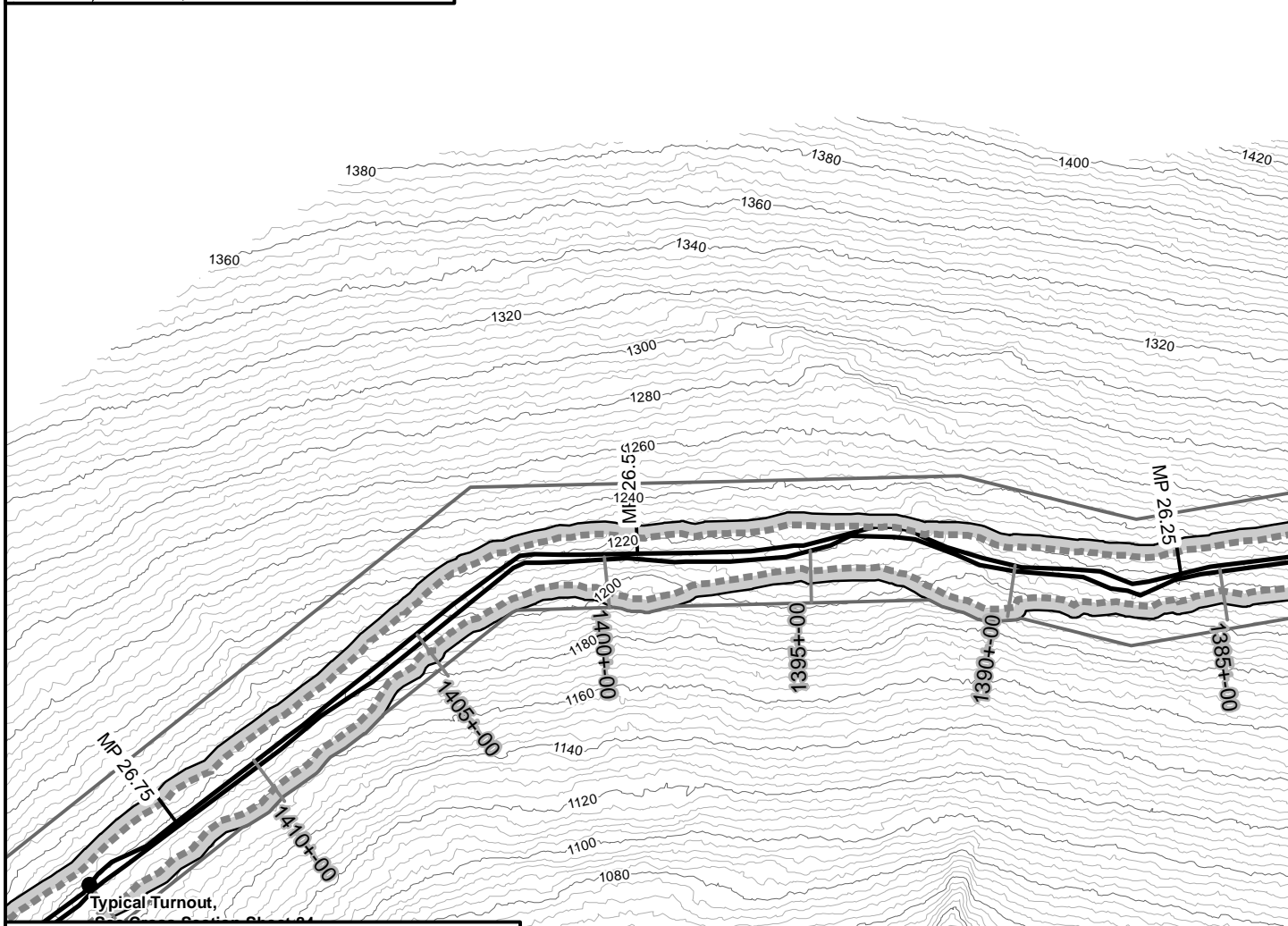
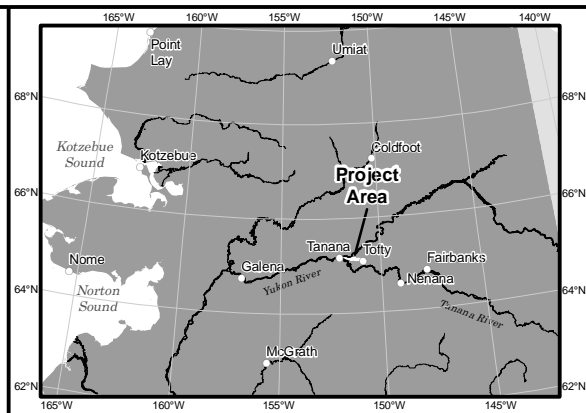
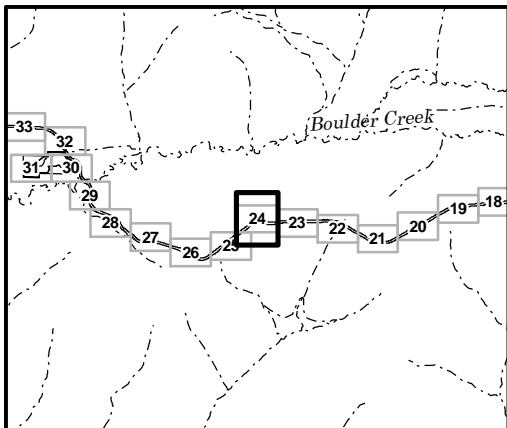

Legend

Cut/Fill Boundary	Material Site
Vegetation Clearing	Culvert: Type A & B Pipe (See Cross Section Figures 70, 71, 72 & 73)
Vegetative Screen/Buffer	Culvert: Fish Pass Pipe (See Cross Section Figures 94, 95, 72 & 73)
3PPI Study Area Boundary (12/05/2012)	MS Section Cut Lines
Wetland	20ft Interval Contour
Upland	4ft Interval Contour
Wetland/Upland Mosaic	3PPI Arcs (12/5/2012)
Navigable Waters	(All drainages are unnamed unless labeled on sheet)
Other Waters	
Previously Disturbed	

Scale 1:5,000
0 150 300 450 Feet

N

STATE OF ALASKA
Department of Transportation and Public Facilities

APPLICANT/AGENT: State of Alaska
2301 Peger Rd. Fairbanks, AK 99709

ROAD TO TANANA PROJECT

61759

Plan View, MP: 26.2 to 26.79

Fish Creek Basin

DATE: FEBRUARY 2013	SHEET: 24 of 110
---------------------	------------------

Q:\Projects\280_3PPI\tanana_2012\mxds_40\ARDL_Tanana_404_Corps_5K_8x11_1of66_v01.mxd 02/08/13 01:15 PM